

# Series 700 Submersible Transducers - Options



## Pressure Ranges

The standard stocked pressure ranges are: 0.25bar, 0.5bar and 1bar G. Optional pressure ranges are available to order for ranges up to 20 bar G.

## Optional Outputs

Standard models use a 4-20mA output. The following output types are optionally available:

Output	Excitation	Max. current
0 to 5VDC	9 to 30VDC	3.5mA
2.5 to 10 mV/V ratiometric	2.5 to 10VDC depending on range	3.5mA
0-100mV non-ratiometric	5VDC	3.5mA

## Static Accuracy Ranges

Model	Static accuracy	Thermal error
PS700	±1.00%	±0.10%
PS710	±0.50%	±0.05%
PS720	±0.25%	±0.05%
PS730	±0.10%	±0.05%

## Nose Caps

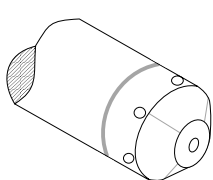

CLOSED FACED  
Part no.: PS-42-01-1314

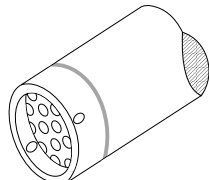

OPEN FACED (STANDARD)

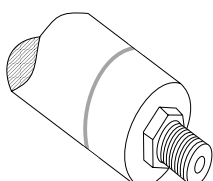

1/4" NPT MALE  
Part no.: PS-OPTION-017

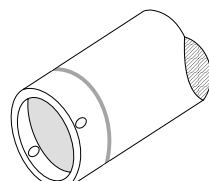

PIEZOMETER  
Part no.: PS-OPTION-006

## Conduit Adaptor

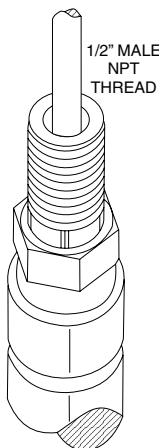

## Lightning/Surge Protection

Protection is achieved through the use of 2 protectors. One is housed in a 4 inch long, 1 inch OD 316 SS tube attached directly to the non-pressure sensing end of the transducer while the other is located at the surface and grounded. Featuring quick response and low clamping voltages, these devices protect against fast rising voltage transients as well as severe current surges associated with lightning discharges in excess of 20,000 amperes. Following a surge, the protector automatically restores the line to normal operation and awaits the next surge without having to reset a breaker or replacing a fuse.

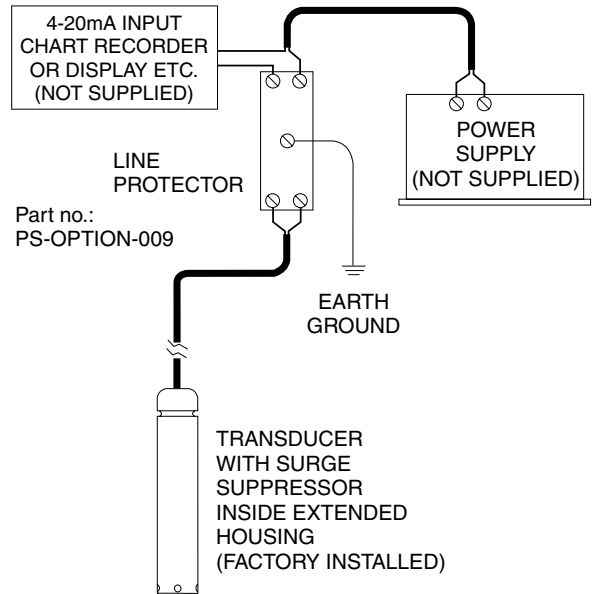

## Cable

Polyurethane cable jacket standard, Tefzel jacket optionally available.

## Aneroid Bellows

For those applications where periodic maintenance is not practical, the Series 815 Aneroid Bellows is a direct replacement for the vent filter. This sensitive bellows responds to and transmits changes in atmospheric pressure to the sensor while remaining a maintenance-free, closed system. It should be noted, however, that the Bellows may not be suitable replacement for the desiccant cartridge in applications where extremely high accuracy is required, usually 0.1% or better. The user is cautioned to evaluate a Bellows in the specific application intended.

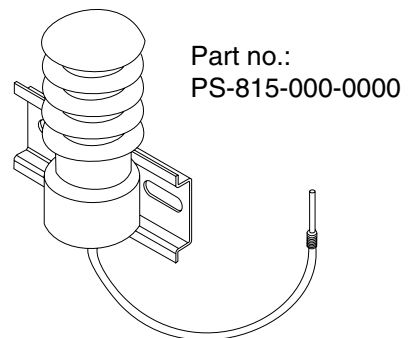

Part no.:  
PS-815-000-0000