

SG-ST Series

Tension and Compression S-Type



Specifications

Nominal Capacity	50kg to 20t
Nominal Output at capacity	2mV/V \pm 0.1%
Factory calibration mode	compression
Linearity error	0.017%
Repeatability	0.01%
Zero return, creep (30 mins)	0.015%
Temp effect span/10°C	0.01%
Temp effect zero/10°C	0.015%
Insulation resistance - bridge to ground	>5000M Ω
Insulation resistance - cable to ground	>1000M Ω
Compensated temperature range	-10° to 50°C
Output resistance	352.2 Ω
Input resistance	410 Ω nominal
Service load	100% of capacity
Safe load	150% of capacity
Mechanical failure	>300% of capacity
Recommended excitation	5V to 15V AC/DC
Maximum Excitation	15VDC
Environmental protection	IP65

All specifications are a maximum, as a % (\pm) of full load, unless otherwise stated

- Capacities 50kg to 20t
- Tool Steel Construction
- Electroless nickel plated
- Tension and compression universal loading
- Can be used for multi-point weighing or scale conversion
- Temperature compensation, both zero and span
- Moisture protected
- Compatible with international standard fittings
- Compact, lightweight and easy to handle

Capacity	Order Code
50kg	SG-ST-50
100kg	SG-ST-100
250kg	SG-ST-250
500kg	SG-ST-500
1t	SG-ST-1T
2.5t	SG-ST-2.5T
5t	SG-ST-5T
10t	SG-ST-10T
20t	SG-ST-20T

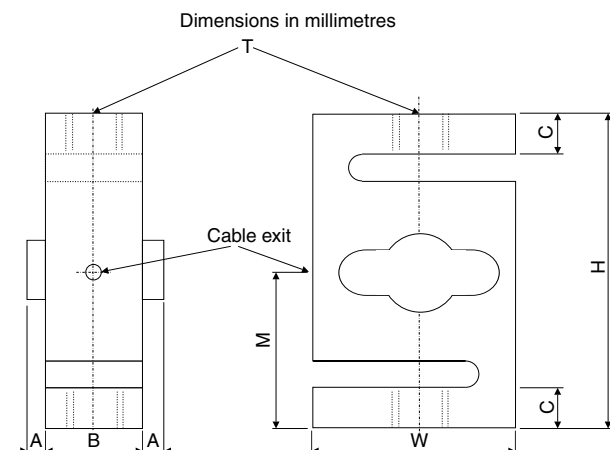

SG-ST	A	B	C	H	M	T	W
50	4	13	10.6	63.5	31.75	¼" x 28P UNF	51
100	4	13	10.4	63.5	31.75	¼" x 28P UNF	51
250	4	25	14.3	76	38	½" x 20P UNF	51
500	4	25	14.3	76	38	½" x 20P UNF	51
1T	4	25	14.3	76	38	½" x 20P UNF	51
2.5T	0	30	20.3	102	51	¾" x 16P UNF	76
5T	0	30	20.3	102	51	¾" x 16P UNF	76
10T	0	48	39.5	150	75	1¼" x 12P UNF	125
20T	0	58	40	160	80	1¼" x 12P UNF	158



SG-ST Series Accessories and Wiring Specifications

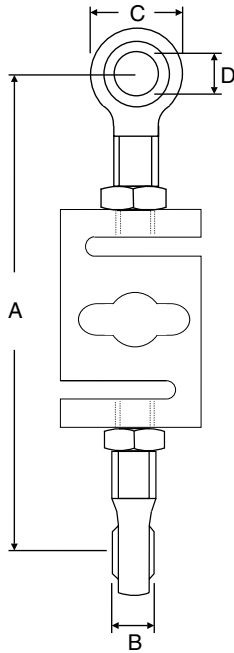

SG-ST	50kg 100kg	250kg - 1T	2.5T - 5T	10T	20T
A	130	175	200	280	288
B	9.53	15.88	22.23	34.93	34.93
C	19.05	33.32	44.45	69.85	69.85
D	6.35	12.7	19.05	25.4	25.4

Rod ends are used with the SG-ST load cell for tension applications. They are used singularly or in pairs and provide ease of installation with self aligning action.

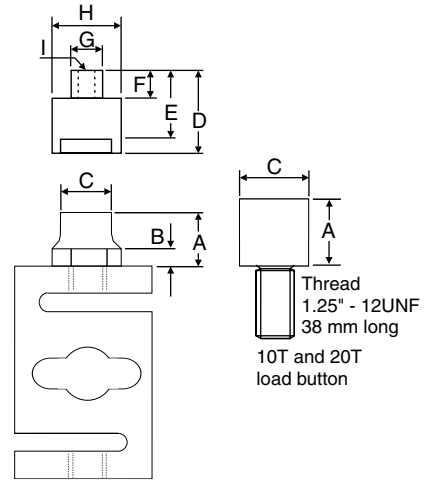

SG-ST	50kg 100kg	250kg - 1T	2.5T - 5T	10T	20T
A	12	12	18	22	22
B	5	5	8	N/A	N/A
C	14	14	20	44.5	44.5
D	21	21	29	30	30
E	18	18	25	18	18
F	8	8	9	10	10
G	10	10	16	75	75
H	20	20	30	60	60
I	M6 x 1P x 10mm	M6 x 1P x 10mm	M10 x 1.5P x 15mm	N/A	N/A

A load button and hardened socket is used with the SG-ST in compression applications. With the load cell rigidly fixed at the base, load is applied through the socket. If a load button is attached top and bottom the load cell converts to self centring pendle acion

SG-ST	50 - 100kg	250kg - 1T	2.5T	5T	10T	20T
Rod end bearing	SG-A-RE0.250	SG-A-RE0.500	SG-A-RE0.750-2	SG-A-RE0.750-5	SG-A-RE1.250-10	SG-A-RE1.250-20
Load button	SG-A-LB0.250	SG-A-LB0.500	SG-A-LB0.750	SG-A-LB0.750	SG-A-LB1-250	SG-A-LB1-250
Load socket	SG-A-LS20	SG-A-LS20	SG-A-LS30	SG-A-LS30	SG-A-LS75	SG-A-LS75

WIRING SPECIFICATIONS

RED	+ Excitation
BLACK	- Excitation
GREEN	+ Signal
WHITE	- Signal
BROWN	+ Sense
BLUE	- Sense

CABLE LENGTH

Cable is 4 core (without sense) or 6 core (with sense) silver grey quality PVC sheathed with screen and is of type and length as follows.

SG-ST 50kg - 1T	3 metres 4 core
SG-ST 2.5T - 5T	5 metres 6 core
SG-ST 10T - 20T	5 metres 6 core

LOPT_ST-2.0-0